

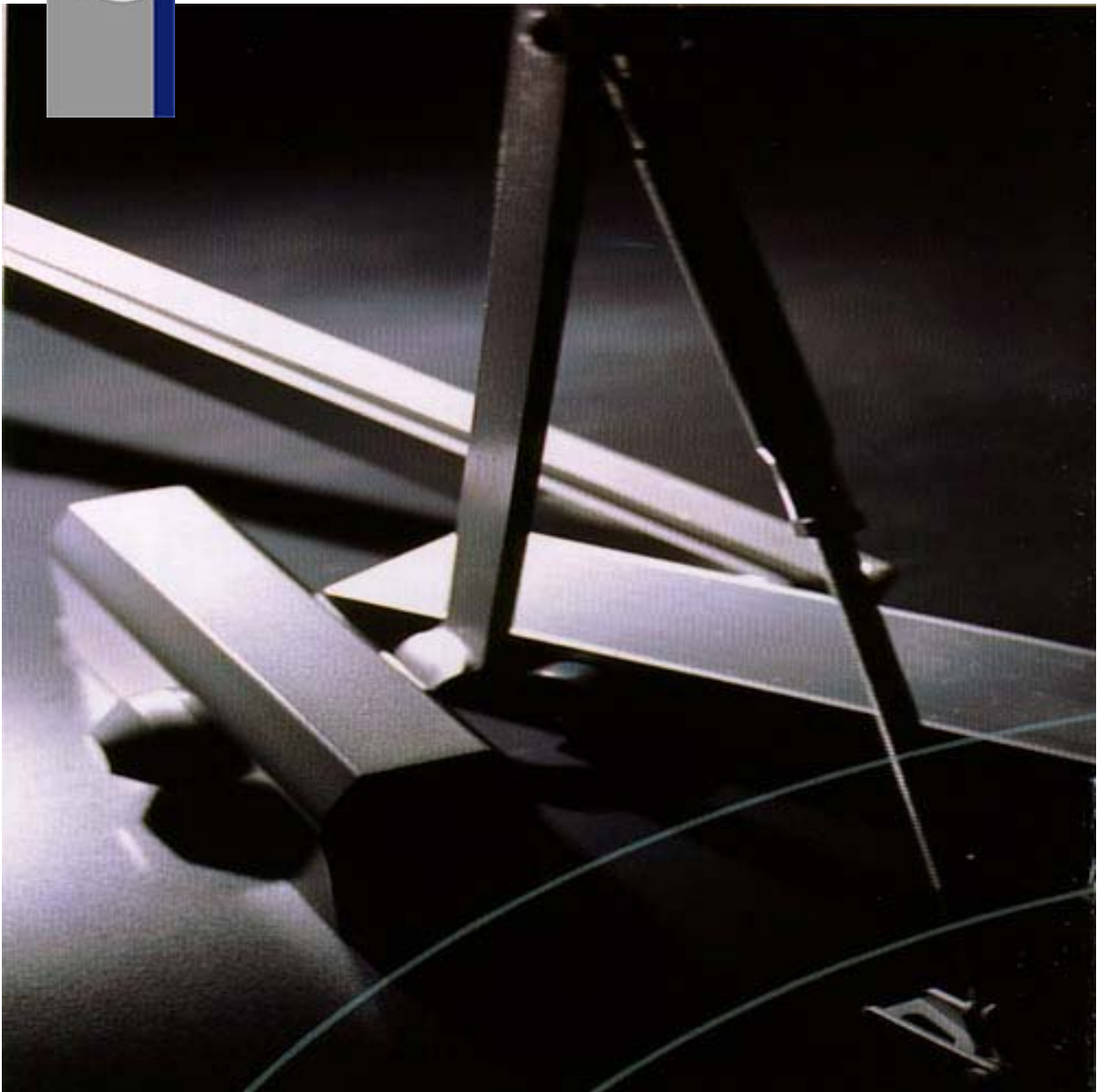

G005 Professional Door Closer

Glutz

***The latest millenium technology
in surface mounted Door or concealed
Transom Closers or Floor Spring.***



- *Extruded anodised or Die-cast Aluminium body,
keeps your doors always smooth in action.*

Door Closer

H a r d w a r e A c c e s s o r i e s



PDC-500 series

Good for ADA Application
 Non-Handed Installation Adj.
 Closing/Latching Speed Power
 Adjustable To Suit All Applications.

PDC-770 series

Compact & Budget Choice
 Adj.Back Check (optional)
 Adj.Closing/Latching speed
 4 Power Size Available.

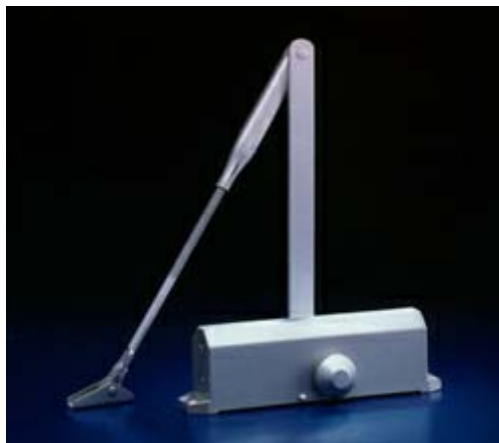

PDC-730 series

Non-Handed Installation Universal
 Application Back Check (Optional)
 Adjustable Closing & Latching Speed.

PDC-830 series

Adj.Spring Power Universal Application
 installation back Check (Optional)
 Non-Handed Delayed Action (Optional)
 Adj. Closing & Latching Speed.



Concealed Transom Closer & Floor Spring

H a r d w a r e A c c e s s o r i e s



PDC 420 series Concealed Track Arm
with Hold-open non-Handed installation
Adj.Closing & Latching Speed



PFS-800 series Floor Spring
In 3 different spring size available.
For up to 300 Kg. doors

PFS-840 series Floor Spring
In 3 different spring size available.
For up to 115 Kg.doors

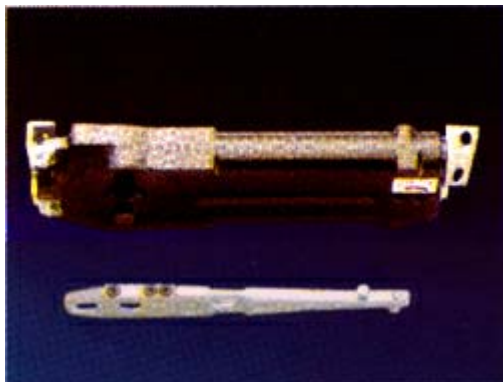

PTC-850 series Concealed Transom Closer
In 3 different spring size available.

PDC-770 series

Surface Mounted Door Closer



● **Certificated & Approvals**

- Manufactured by quality assured ISO9002 factory since 1993.
- UL Listed no.R10469.
- Fire tested Australia standard 1530 Part 4-1997 and 1905 Part 1.
- Fire tested in UK.BS 476 Part 22:1987 (WFRC No.C122647)
- 500,000 cycles passed.

● **Warranty**

PDC770 series door closer is guaranteed for 5 years from the date of manufacture against any defects in material or workmanship. Defective product will be replaced with in new unit; but no claim for damage incurred or work done thereon will be allowed. This guarantee is void if the product has been subject to misapplication or abuse.

● **Construction & Technical Details**

- Constructed with precise aluminium die-cast body with steel arm
- Heat treated steel rack & pinion immersed in high grade oil operate a nest of coils to give a smooth precise action & minimum wear.
- Stable hydraulic fluid for any climatic operation & constant lubrication.

Function & Technical Details

Surface Mounted Door Closer

● Function

- Available for 4 different power sizes can be used on interior or exterior doors.

PDC770	1	2	3	4
Max.Door Width (mm)	800mm (31.5")	900mm (35")	950mm (37.4")	1050mm (41.3")
Max.Door Weight (kgs)	30kgs (66 lbs)	45kgs (100 lbs)	65kgs (143 lbs)	85kgs (187 lbs)

○ Adjustable Closing & Latching Speed

- 1 = Closing Speed Adjusting Valve, range 180°~15°
- 2 = Latching Speed Adjusting Valve, range 15°~0°

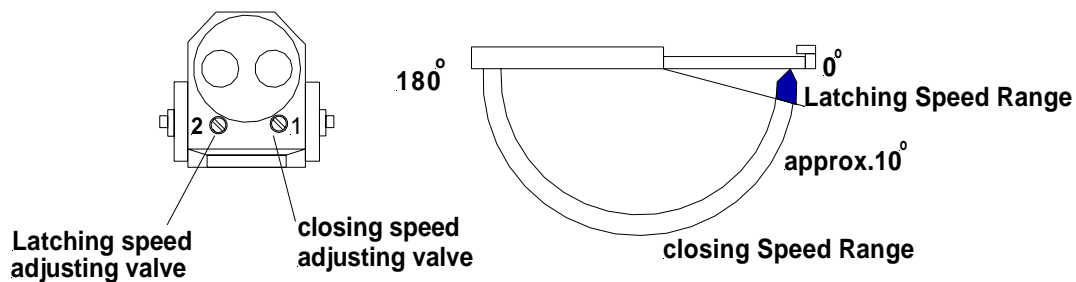

Closing and Latching Speed

○ Adjustable back check (Optional)

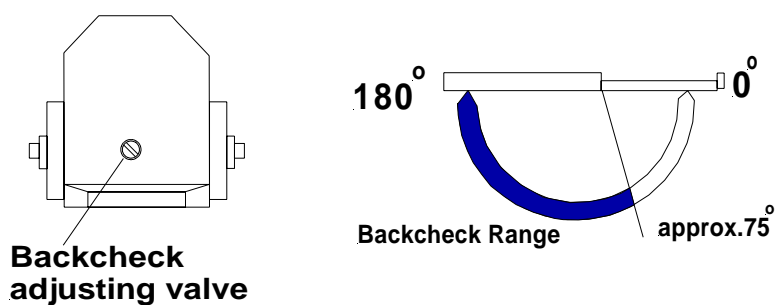

Adjusting Backcheck

○ Built-in hold open (Optional)

Hold door open your desired angles between 80o~180o

○ Universal application & non-handed installation

Standard Arm, Hold-open Arm & Parallel bracket are available.

○ Maintenance

Check quarterly to ensure all fixings are secure and adjust, if necessary, the closing and latching speed so that the door operates both functionally and smoothly.

PDC-500 series

Surface Mounted Door Closer



● **Certificated & Approvals**

- Manufactured by quality assured ISO9002 factory since 1993.
- 500,000 cycles passed.
- ANSI Grade 1 Compliance.

● **Warranty**

PDC500 series door closer is guaranteed for 5 years from the date manufacture against any defects in material or workmanship.

Defective product will be replaced with in new unit;but no claims for damage incurred or work done thereon will be allowed. This guarantee is void if the product has been subject to misapplication or abuse.

● **Construction & Technical Details**

- Constructed with precise aluminium die-cast body with steel arm
- Heat treated steel rack & pinion immersed in high grade oil operate a nest of coils to give a smooth precise action & minimum wear.
- Stable hydraulic fluid for any climatic operation & constant lubrication.
- Adjustable spring strength as standard for all applications.

● **Maintenance**

Check quarterly to ensure all fixings are secure and adjust, if necessary, the closing and latching speed so that the door operates both functionally and smoothly.

Function & Technical Details

Surface Mounted Door Closer

● Function

Adjustable Spring Power.

PDC500	5(2-5)
Max.Door Width (mm)	1250mm (50")
Max.Door Weight (kgs)	110 kgs (242 lbs.)

Adjustable Closing & Latching Speed

1 = Closing Speed Adjusting Valve, range 130°~10°

2 = Latching Speed Adjusting Valve, range 10°~0°

Adjustable back check

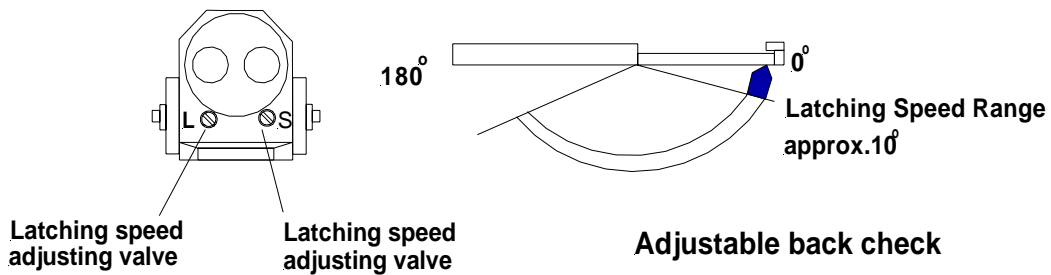

Adjustable back check

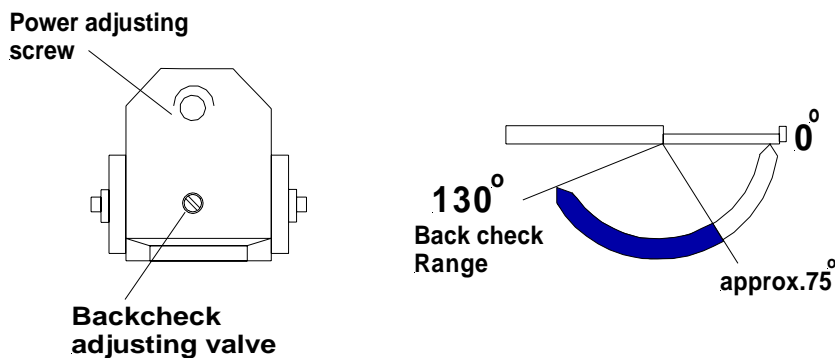

● Delay action available for ADA application

Function from approximately 180°~60° allows easy & unimpeded passage though a doorway. This option is particularly useful in hospitals, senior citizens' homes & entrances to apartment complexes.

● Universal application & non-handed installation.

Standard Arm , Parallel Bracket, Track Arm & Hold-Open Arm are available.

PDC -730 series

Surface Mounted Door Closer



● **Certificated & Approvals**

- Manufactured by quality assured ISO9002 factory since 1993.
- BSI Certificated No.195973 & BG 001767.
- Fire tested Australia standard 1530 Part 4-1997 and 1905 Part 1.
- Fire tested in UK.BS 476 Part 22:1987 (WFRC No.C122647)
- 2,000,000 cycles passed.
- BS EN1154 Tested in UK.

● **Warranty**

PDC730 series door closer is guaranteed for 10 years from the date manufacture against any defects in material or workmanship. Defective product will be replaced with in new unit; but no claims for damage incurred or work done thereon will be allowed. This guarantee is void if the product has been subject to misapplication or abuse.

● **Construction & Technical Details**

- Constructed with extruded anodize aluminium body, forged steel arms passively against rust & high quality steel internal components.
- Compact design with minimized projection allowing installation to door having adjacent return wall at 90°
- Heat treated steel rack & pinion immersed in high grade oil operate to give a smooth precise action & minimum wear.
- Stable hydraulic fluid for any climatic operation & constant lubrication.
- Adjustable spring strength as standard for all applications.
- Totally reversible without adjustment.
- Heat treated high tensile springs.
- Piston & spindle been heat treated for high strength.
- Regular arms are equipped with a power adjustment bracket to increase or decrease closing power.
- Two control valves (latching & closing) concealed behind the front slide cover to give easy adjustment but to prevent unauthorized tempering.
- A built-in pressure relief valve protects the closer against rough use.

Function & Technical Details

Surface Mounted Door Closer

● Function

- Available for 4 different power sizes can be used on interior or exterior doors.

PDC730	2	3	4	5
Max.Door Width (mm)	900	950	1100	1250
Max.Door Weight (mm)	45	65	85	110

● Adjustable Closing & Latching Speed.

- 1 = Closing Speed Adjusting Valve, range 180° ~ 10°
- 2 = Latching Speed Adjusting Valve, range 10° ~ 0°

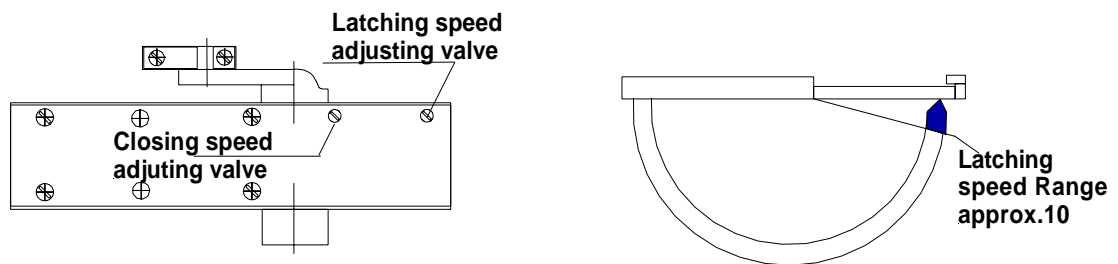

● Built-in Fixing Force Back check (Optional)

The fixed back check function is built in the piston. It Provides a cushioning effect when the door is forcibly thrown open but does not serve as a substitute for a doorstop. Nominal operating range 75° ~ 85° .

● Universal Application & Non-Handed Installation.

Standard Arm, Parallel Bracket, Track Arm & Hold-Open Arm are available. Versatile & easy Installation for both right & left hand doors.

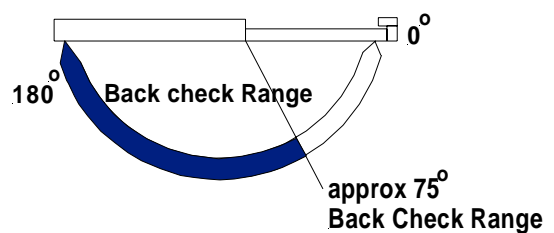

● Maintenance

Check quarterly to ensure all fixings are secure and adjust, if necessary, the closing and latching speed so that the door operates both functionally and smoothly.

PDC -830 series

Surface Mounted Door Closer



● Certificates & Approvals

- Manufactured by quality assured ISO9002 factory since 1993.
- BSI Certificated No.195973 & BG 001767.
- Fire tested Australia standard 1530 Part 4-1997 and 1905 Part 1:1997
- Fire tested in UK.BS 476 Part 22:1987 (WFRC No.C122647)
- 2,000,000 cycles passed.
- BS EN1154 Tested in UK.

● Warranty

PDC830 series door closer is guaranteed for 10 years from the date manufacture against any defects in material or workmanship. Defective product will be replaced with in new unit ; but no claim for damage incurred or work done thereon will be allowed. This guarantee is void if the product has been subject to misapplication or abuse.

● Construction & Technical Details

- Constructed with extruded anodized aluminium body, forged steel arms passively against rust & high quality steel internal components.
- Compact design with minimized projection allowing installation to door having adjacent return wall at 90°
- Heat treated steel rack & pinion immersed in high grade oil operate to give a smooth precise action & minimum wear.
- Stable hydraulic fluid for any climatic operation & constant lubrication.
- Totally reversible without adjustment.
- Heat treated high tensile springs.
- Piston & spindle been heat treated for high strength.
- Regular arms are equipped with a power adjustment bracket to increase or decrease closing power.
- A built-in pressure relief valve protects the closer against rough use.
- All three control valves(latching, closing & back check) concealed behind the front slide cover to give easy adjustment but to prevent unauthorized tempering.

Function & Technical Details

Surface Mounted Door Closer

● Function

Adjustable Spring Power

PDC830	5(2-5)	6(2-6)
Max.Door Width (mm)	1250	1450
Max.Door Weight (kgs)	110	150

● Adjustable Closing & Latching Speed

1 = Closing Speed Adjusting Valve, range 180°~10°

2 = Latching Speed Adjusting Valve, range 10°~0°

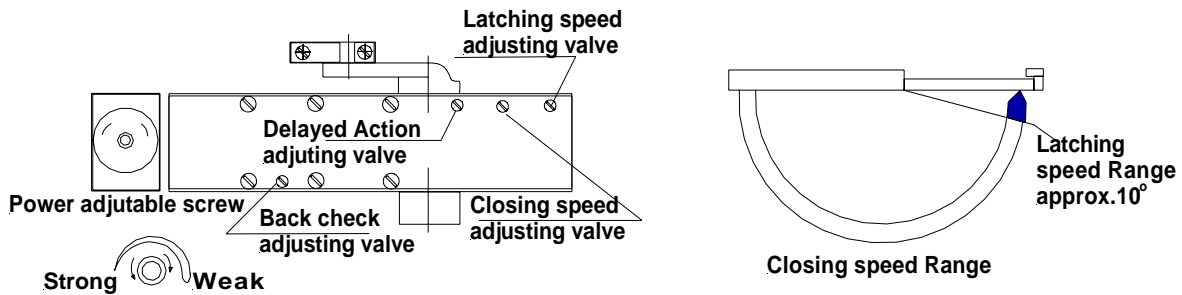

● Adjustable Back check (Optional)

Provides a cushioning effect when the door is forcibly thrown open but does not serve as a substitute for a doorstop. Nominal operating range 75° ~ 85°.

Adjusting Back check

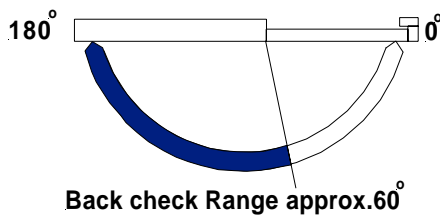

Adjusting Delayed Action

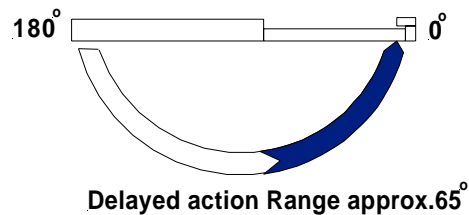

● Adjustable Delayed Action (Optional)

Function from approximately 180° ~ 60° allows easy & unimpeded passage through a doorway. This option is particularly useful in hospitals, senior citizens homes & entrance to apartment complexes.

● Universal Application & Non-Handed Installation.

Standard Arm, Parallel Bracket, Track Arm & Hold-open Arm are available. Versatile & easy installation for both right & left hand doors.

● Maintenance

Check quarterly to ensure all fixings are secure and adjust, if necessary, the closing and latching speed so that the door operates both functionally and smoothly.

PDC 420 Series

Concealed Door Closer



● **Certificated & Approvals**

- Manufactured by quality assured ISO9002 factory since 1993.
- 500,000 cycles passed.

● **Warranty**

PDC 420 series door closer is guaranteed for 5 years from the date manufacture against any defects in material or workmanship. Defective product will be replaced with in new unit; but no claims for damage incurred or work done thereon will be allowed. This guarantee is void if the product has been subject to misapplication or abuse.

● **Construction & Technical Details**

- Constructed with extruded anodized aluminium body & high quality steel internal components.
- Heat treated steel rack & pinion immersed in high grade oil operate to give a smooth precise action & minimum wear.
- Stable hydraulic fluid for any climatic operation & constant lubrication.
- None of components in concealed door closer is visible when the door is closed.
- Heat treated high tensile springs.
- Piston & spindle been heat treated for high strength.

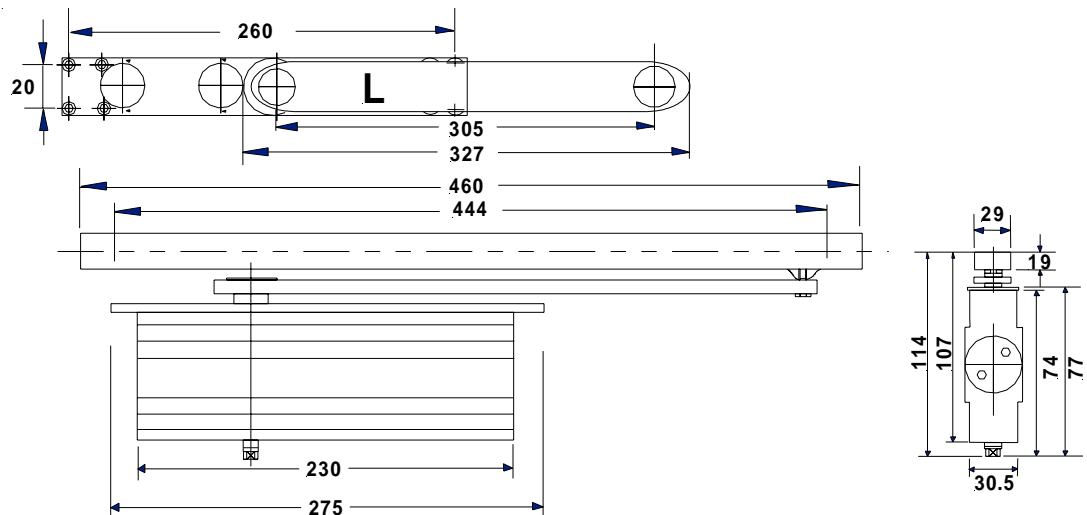

- **Function**
- **Two installation types**
PDC 420 series can be used in a standard installation or over head installation.
- **Standard installation**
The door needs to be at least 36mm thick if it is made of steel.
It must be at least 40mm thick if it is made of wood.
- **Over head installation**
The door needs to be at least 33mm thick if it is made of steel.
It must be at least 37mm thick if it is made of wood.
- **Non-Handed Installation.**
Versatile & easy installation for both right & left hand doors.
- **Available for 2 different power size can be used on interior or exterior doors.**

PDC420	2	3
Max.Door Width (mm)	950x2100	1050x2100
Max.Door Weight (kgs)	50	70

- **Easy & accurate speed adjustment.**
1 = Closing Speed Adjusting Valve, range 180°~15°
2 = Latching Speed Adjusting Valve, range 15°~0°

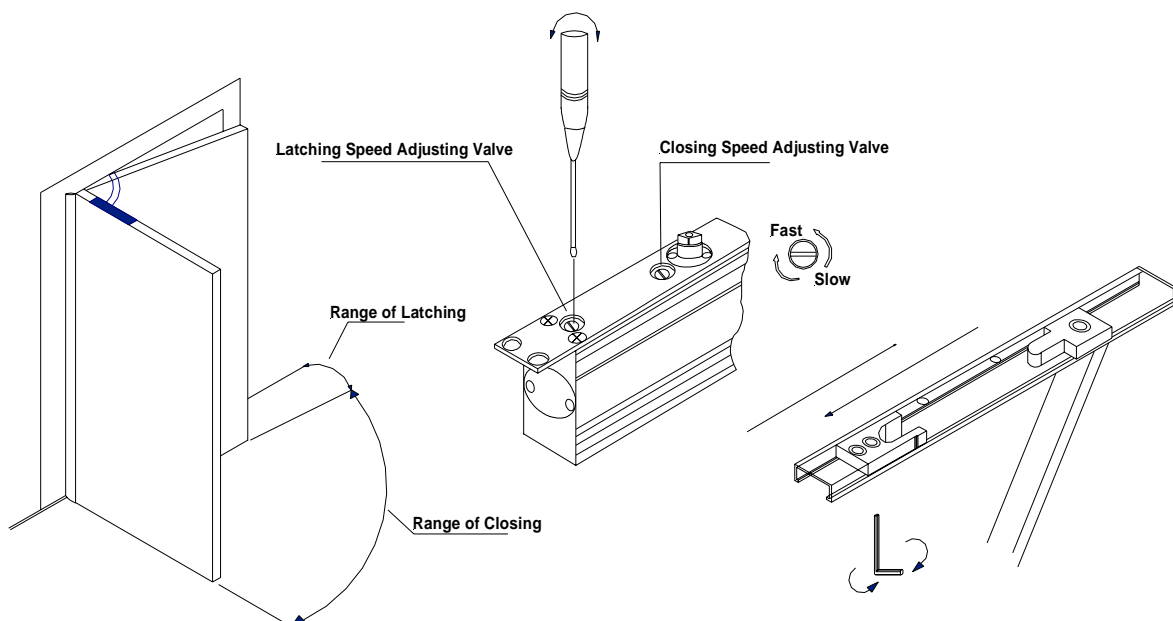

Dimensions & installation.

Standard Arm Installation

on pull side

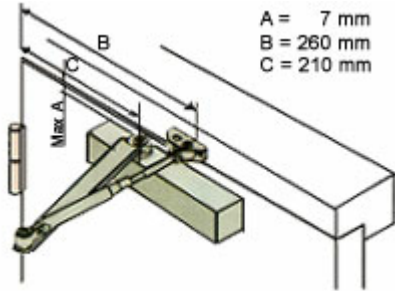

on push side

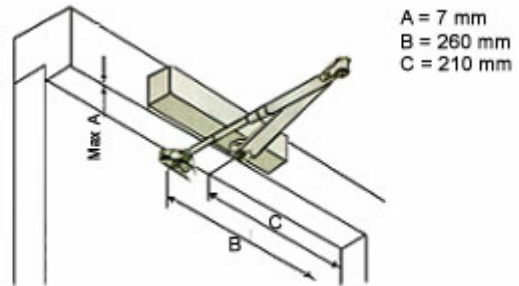

Track Arm Installation

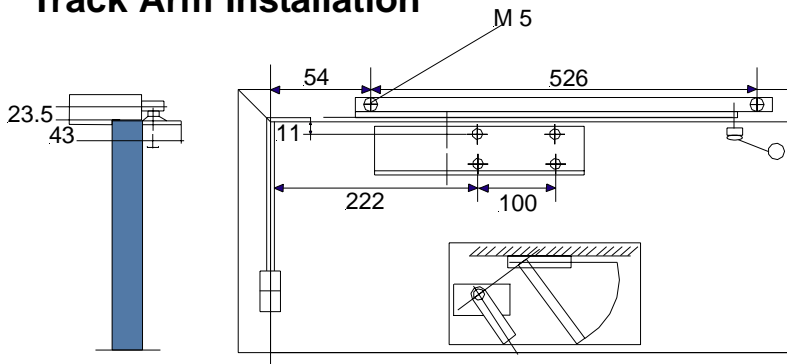

on pull side

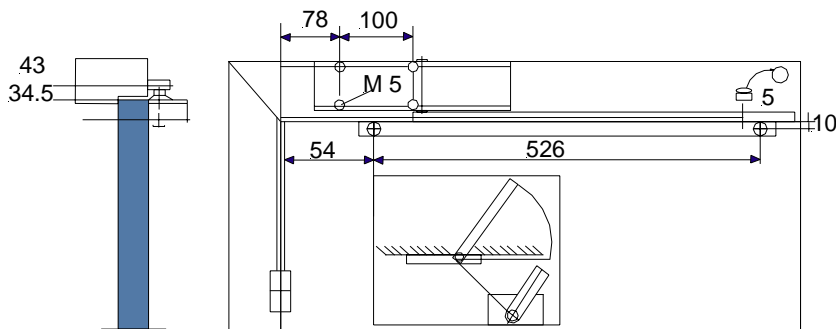

on pull side

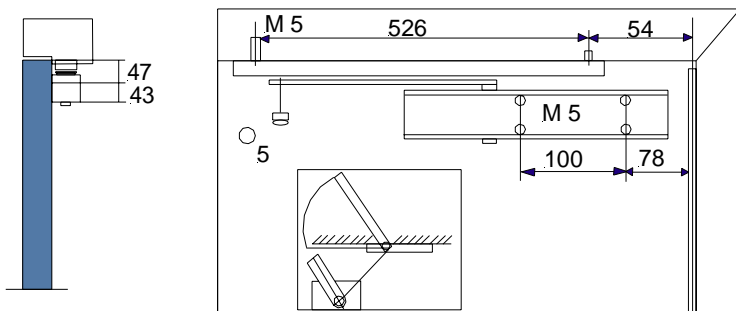

on push side

Dimensions & installation.

Parallel Bracket & Hold-open Arm

on push side

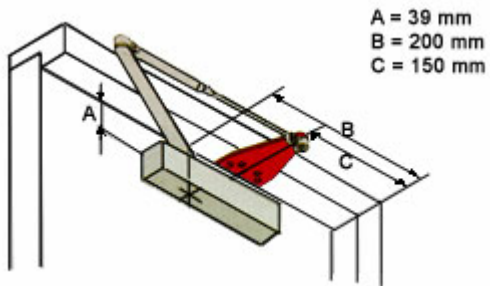

on pull side

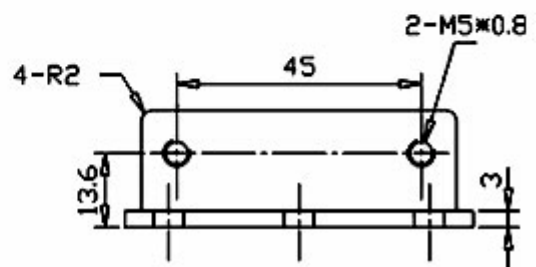
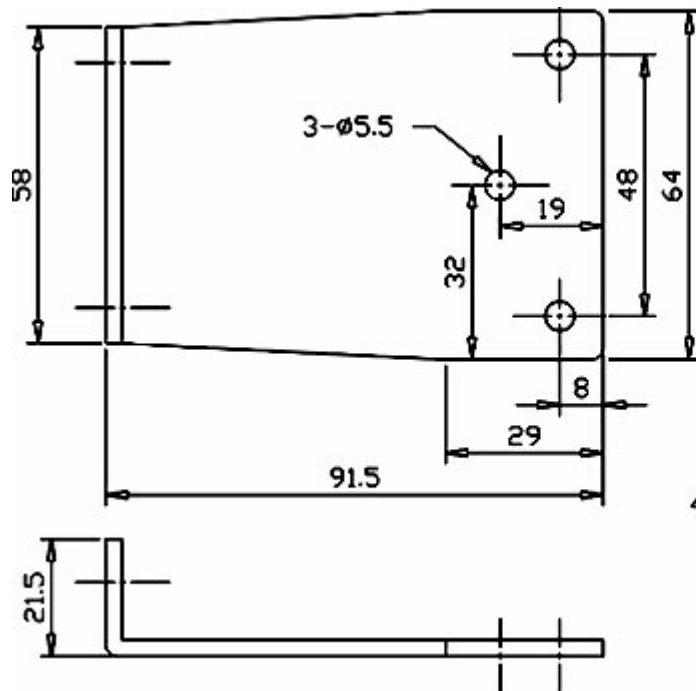
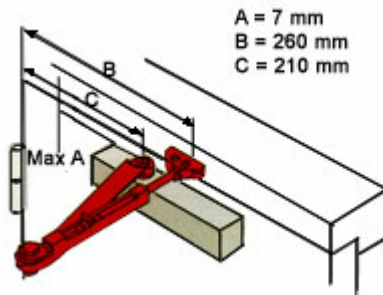

PFS 840 Series

F l o o r S p r i n g

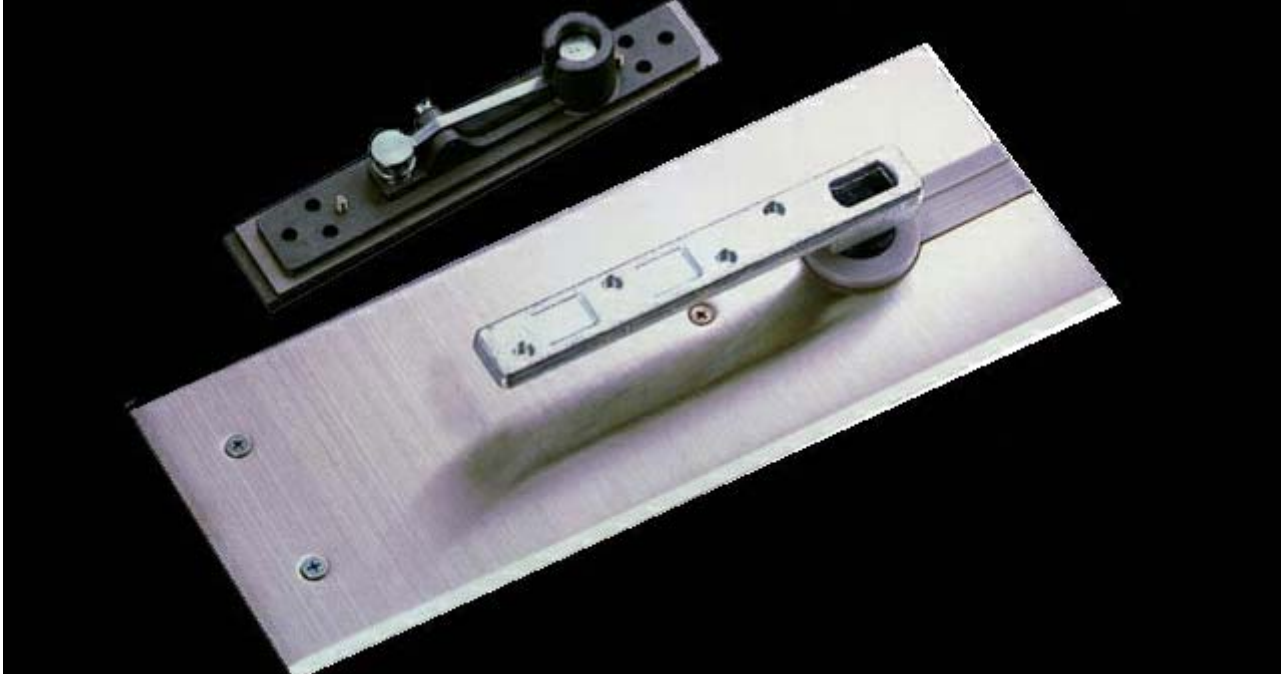

● **Certificates & Approvals**

- Manufactured by quality assured ISO9002 factory since 1993.
- 500,000 cycles passed.
- EN1154 Compliance.

● **Warranty**

- GFS 840 series Floor Spring is guaranteed for 10 years from the date manufacture against any defects in material or workmanship. Defective product will be replaced with in new unit; but no claim for damage incurred or work done thereon will be allowed. This guarantee is void if the product has been subject to misapplication or abuse.

● **Maximum door opening angle of 130°**

● **Built-in cushioned stop from approx. 85°**

If adjacent structures interfere with maximum degree of door opening, an auxiliary doorstop should be installed.

● **Mechanical hold-open at 90° (Optional at 105°)**

● **High efficiency power transfer, low opening moment.**

● **Closer mechanism adjustment in loose box for**

● **Maintenance**

Check quarterly to ensure all fixings are secure and adjust, if necessary, the closing and latching speed so that the door operates both functionally and smoothly.

● **Function Adjustable Closing & Latching Speed.**

Two non-critical control valves provide dual speed hydraulic closing (closing from 130° ~ 15°, latching from 130° ~ 0°)

Hold open 90 degree or Non-Hold open

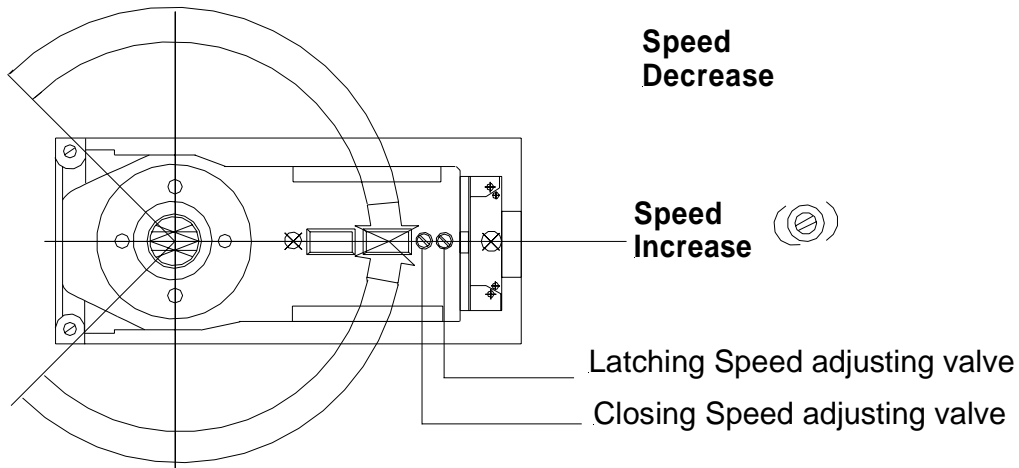

Hold open 90 degree or Non-Hold open

□ Closing range 130 degree ~ 15 degree
 ■ Latching range 15 degree ~ 0 degree

Length 9mm	Width	Height 4mm
------------	-------	------------

○ **Available in Light, Medium & Heavy.**

Spring	Closing Force	Max.Door Width
Light	16Nm (11.5fL-lbs.)	Max.850mm (33.5")
Medium	19Nm (13.7fL-lbs.)	Max.950mm (37.4")
Heavy	26Nm (18.7fL-lbs.)	Max.1100mm (43.3")

Note :

The listed door widths & recommended closer size are average conditions. In case of tall heavy doors or where doors are subject to wind or draft condition, the next large closer size should be selected.

Note :

Accommodates doors up to a maximum weight of 115 kgs.(250lbs.)

Construction & Technical Details

- One unit for both single & double action doors where surface mounted closer cannot be fitted.
- High grade cast iron mechanism body is housed within a galvanized steel loose box which is zinc protected & painted for corrosion resistance.
- Internal mechanism components utilizing heat treated high alloy steel & ball bearing for optimum efficiency.
- Stable hydraulic fluid for any climatic operation & constant lubrication.
- Suitable for timber, metal & tempered glass doors.
- Built-in pressure relief valve protects the closer from rough use.
- Closer mechanism totally immersed in hydraulic fluid.

Note

On single action centre-pivot doors it is recommended that a local door stop is fitted at the head to prevent the door swinging through when using electric strikes and latches.

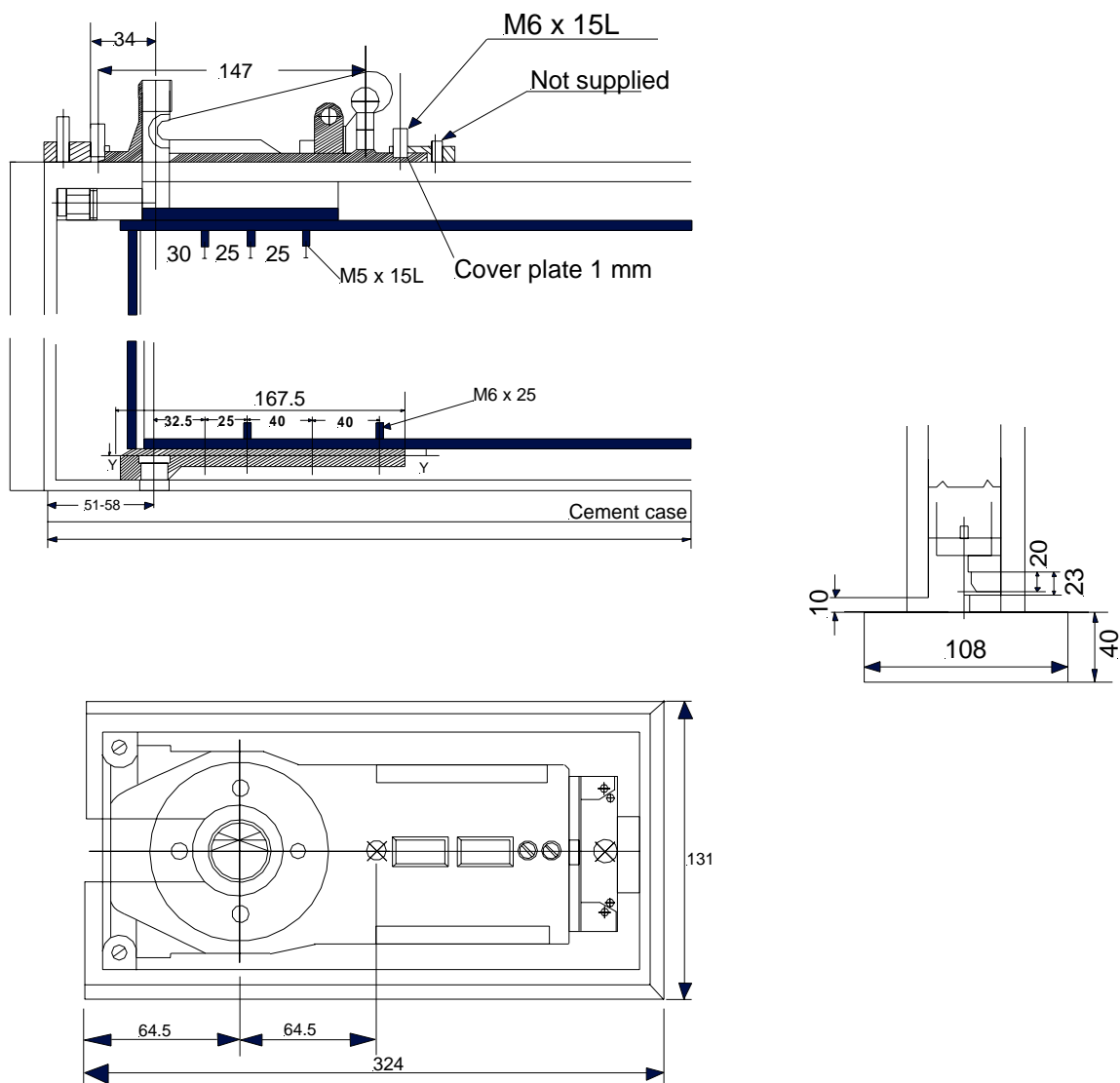

PFS-800 Series

Double Action Heavy Duty Floor Spring



- **Certificates & Approvals**
 - Manufactured by quality assured ISO9002 factory since 1993.
 - 500,000 cycles passed.
 - EN1154 Compliance.
- **Warranty**

GFS 840 series Floor Spring is guaranteed for 10 years from the date manufacture against any defects in material or workmanship. Defective product will be replaced with in new unit; but no claim for damage incurred or work done thereon will be allowed. This guarantee is void if the product has been subject to misapplication or abuse.
- **Double Action Heavy Duty Floor Spring**
- **Specifically designed for high traffic and high wind areas**
- **Capable of operating doors up to 300kg**
- **Suitable for doors up to 1400mm wide**
- **Fully adjustable hold open or no hold open features from 75° to 180° in either direction**
- **Closing force available 15/35/54 Nm**
- **Interchangeable pivots from 5mm to 50mm in height**
- **Maintenance**

Check quarterly to ensure all fixings are secure and adjust, if necessary, the closing and latching speed so that the door operates both functionally and smoothly.

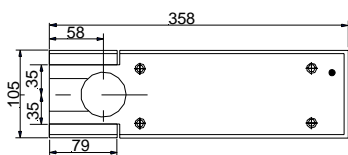

Application for centre pivoted door

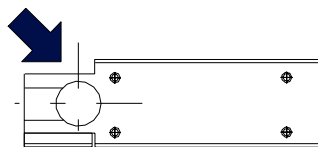

Application for LH offset pivoted door

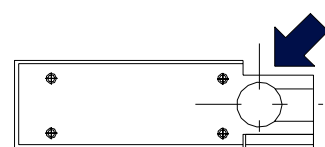

Application for RH offset pivoted door

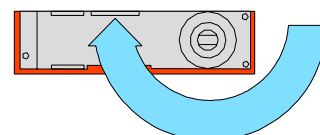
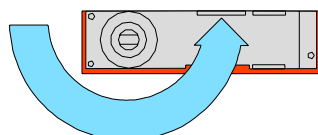
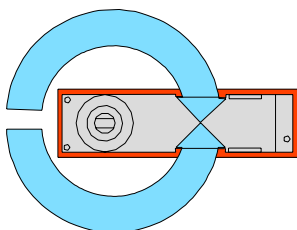

Function & Technical Details

Double Action Heavy Duty Floor Spring

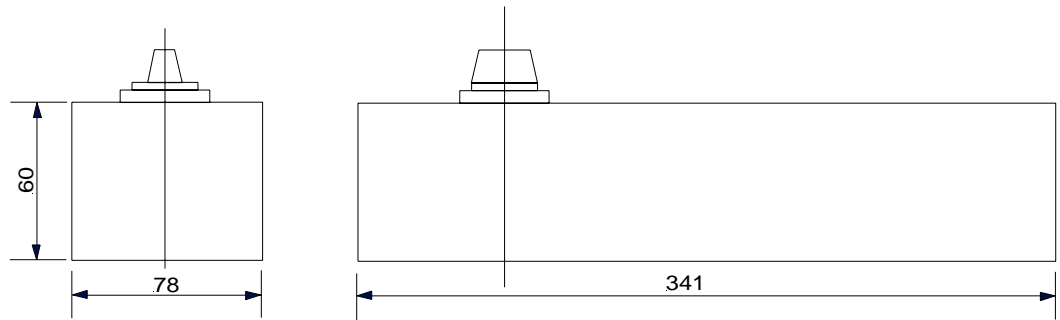

1. Closing speed adjustment Valve
2. Hold-open or delayed action valve
3. Adjustment screw for varying the start of the end point of the delayed action range.

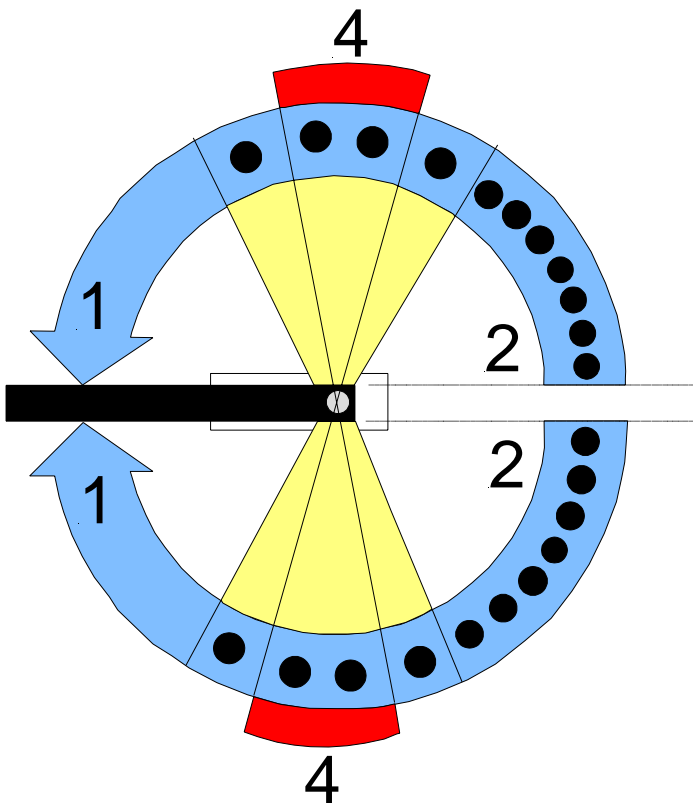
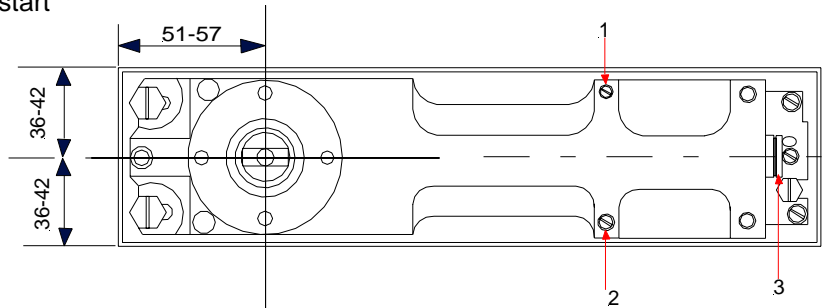

1. Fully controlled closing with adjustable speed.
2. Hold-open range or delayed action range (approx. 75° to 180°)
3. Adjustment range-point at which hold-open begins or end of delayed action range (approx. 75° to 105°)
4. Mechanical backcheck (from approx. 80°)

PTC 850 series

C o n c e a l e d T r a n s o m C l o s e r



● Certifications & Approvals

- Manufactured by quality assured ISO9002 factory since 1993.
- 500,000 cycles passed.
- ANSI Grade 2

● Warranty

PTC 850 series Overhead Concealed Transom Closer is guaranteed for 10 years from the date manufacture against any defects in material or workmanship. Defective product will be replaced with in new unit ; but no claim for damage incurred or work done thereon will be allowed. This guarantee is void if the product has been subject to misapplication or abuse.

● Construction & Technical Details

- One unit for both single & double action doors where surface mounted closer cannot be fitted.
- Compact body size fits in 44.5mm x 100mm (1 3/4"x4") header.
- High grade cast iron mechanism body.
- Internal mechanism components utilizing heat treated high alloy steels & ball bearing for optimum efficiency.
- Stable hydraulic fluid for any climatic operation & constant lubrication.
- Suitable for timber & metal doors.
- Built-in pressure relief valve protects the closer from rough use.
- Closer mechanism totally immersed in hydraulic fluid.

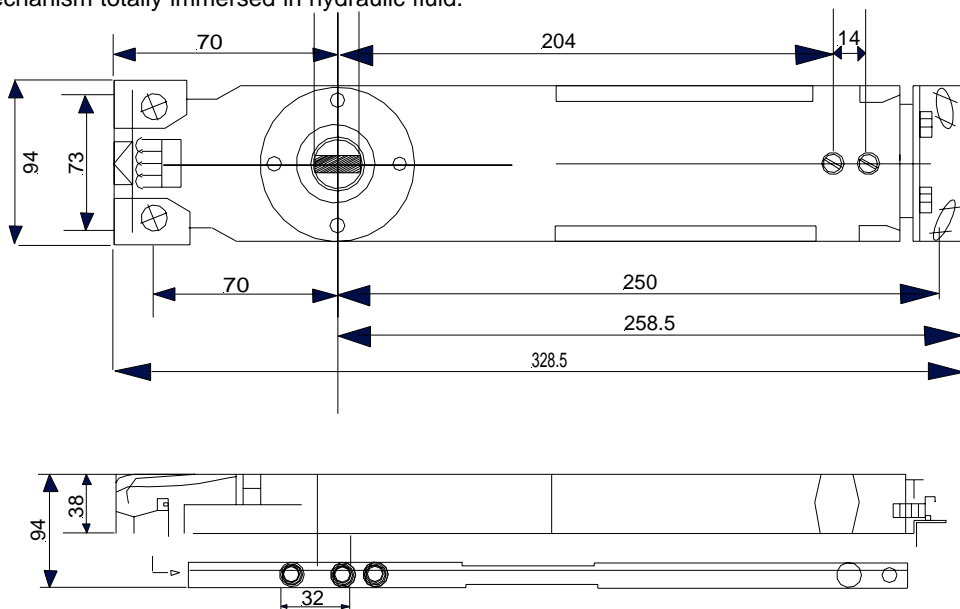

131

Function & Technical Details

C o n c e a l e d T r a n s o m C l o s e r

● **Function**

○ **Adjustable Closing & Latching Speed.**

Two non-critical control valves provide dual speed hydraulic closing (closing from 130° ~ 15°, latching from 130° ~ 15°)

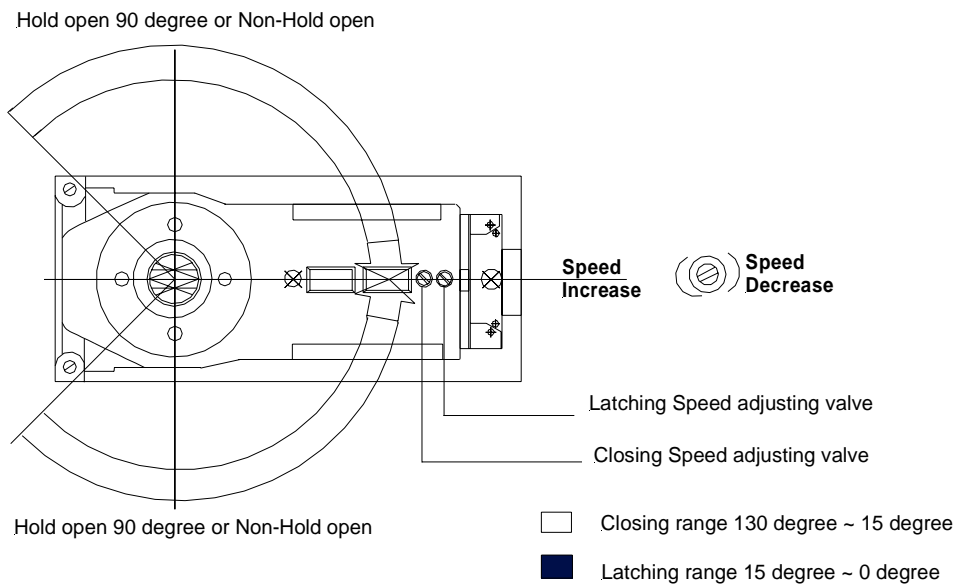

- **Maximum door opening angle of 130°**
- **Built-in cushioned stop from approx 85°**
If adjacent structures interfere with maximum degree of door opening, an auxiliary doorstop should be installed.
- **Mechanical hold-open at 90° (Optional at 105°)**
- **High efficiency power transfer, low opening moment.**
- **Available in Light, Medium & Heavy.**

Spring	Closing Force	Max.Door Width
Light	21Nm (15fL-lbs.)	Max.900mm (35.4")
Medium	29Nm (2fL-lbs.)	Max.1050mm (41.3")
Heavy	40Nm (29fL-lbs.)	Max.1220mm (48")

Note

On single action centre-pivot doors it is recommended that a local door stop is fitted at the head to prevent the door swinging through when using electric strikes and latches. The listed door widths & recommended closer size are average conditions. In case of tall heavy doors or where doors are subject to wind or draft condition, the next large closer size should be selected. Accommodates doors up to a maximum weight of 115 kgs.(250lbs.)

The Complete Range

Hardware Accessories

Professional Line Door Closer Ordering Information

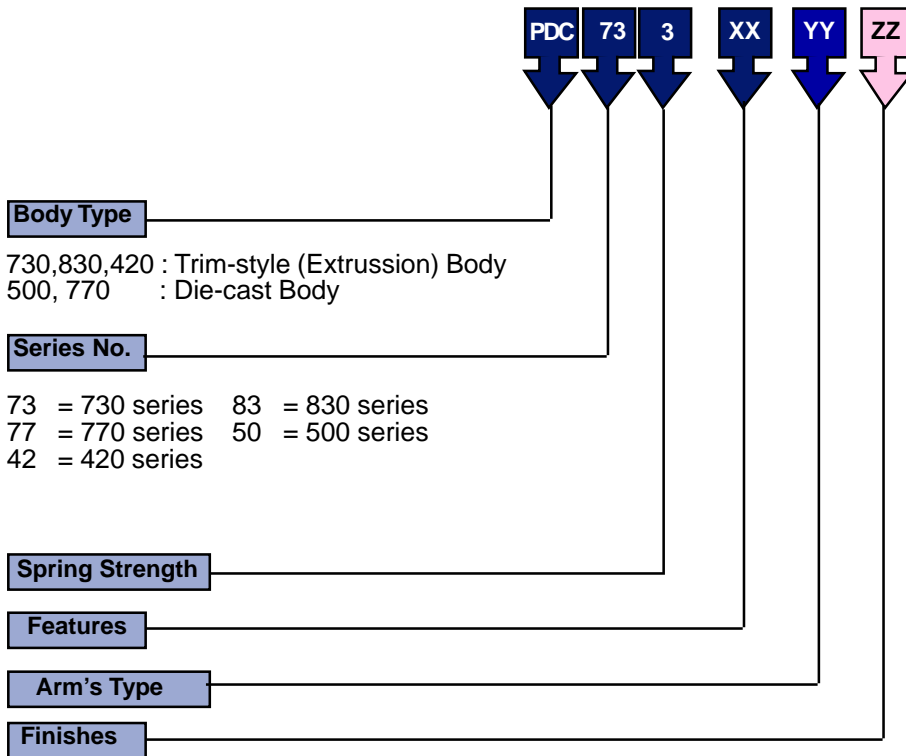

Features	
SD	Standard
BC	Fixed Back-check
AB	Adjustable Back-check
DA	Adjustable Delayed Action
BH	Build-in Hold-open
BD	Fixed Back-check+Delayed Action
AD	Adjustable Back-check + Delayed Action
Arm's Type	
SA	Standard Arm
HO	Hold-open Arm
HF	Hold-open Arm w/Fuse
PA	Parallel Arm
TA	Track Arm
Features	
AS	Silver
BR	Bronze
GA	Gold
BK	Black (RAL-9005)
WT	White (RAL-9016)
IV	Ivory (RAL-1015)

Floor spring & Transom closer ordering information

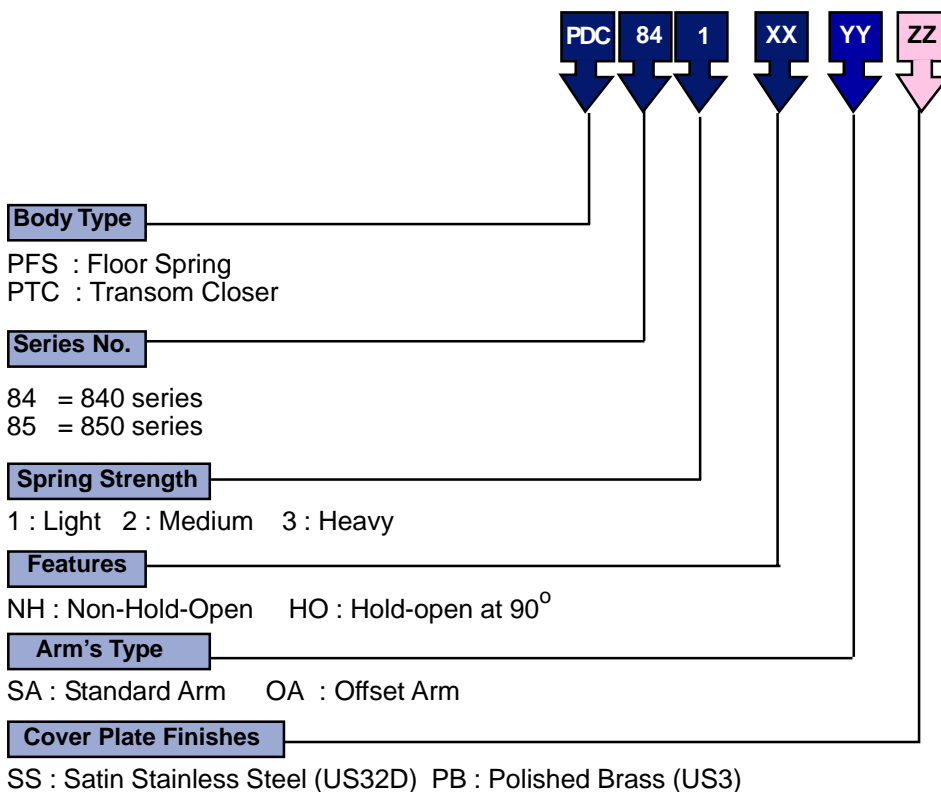

The Complete Range

H a r d w a r e A c c e s s o r i e s

With the right closer for each door, each application and every requirement										
EN 1154 Standard			Surface Mounted Door Closer Extruded Anodize Aluminum Die-Aluminum body				Concealed	Floor Spring		Transom Closers
Recommended Door Width	Closing Moment Between		PDC 730	PDC 830	PDC 770	PDC 500	PDC 420	PFS 840	PFS 800	PTC 850
Standard Doors Up to	<750mm	9Nm~13Nm								
	<850mm	13Nm~18Nm	732		771			841	851	
	<950mm	26Nm~37Nm	733		772			842	852	851
	<1100mm	26Nm~37Nm	734		773	504	422	843	852	852
	<1250mm	37Nm~54Nm	735	835	774	505	423			853
	<1400mm	54Nm~87Nm		836					853	
Adjustable Sweep Speed & Latching Speed			●	●	●	●	●	●	●	●
Hold-open	Build-in (Standard open at 90 for PDC840, PTC850)				X			X	X	X
	Hold - open Arm		X	X		X			X	
Back-check	Build-in Fixed Force		X							
	Adjustable Force			X		●				
Arm	Standard (Strap arm for PFS840, PTC850)		●	●	●	●		●	●	●
	Parallel Bracket		X	X	X	X				
	Track with or without Hold-Open		X	X		X	●			
	Fusible-Link Hold-Open		X							
	Offset Arm							X	X	X
Adjustable Spring power				●		●				
Adjustable Delayed Action				X						
Non- Handed			●	●	●	●	●	●	●	●

Remark : “ ● “ Standard

“ X “ Optional

The manufacturer reserve the right to change the specifaion without prior notice.

Dimensions

H a r d w a r e A c c e s s o r i e s

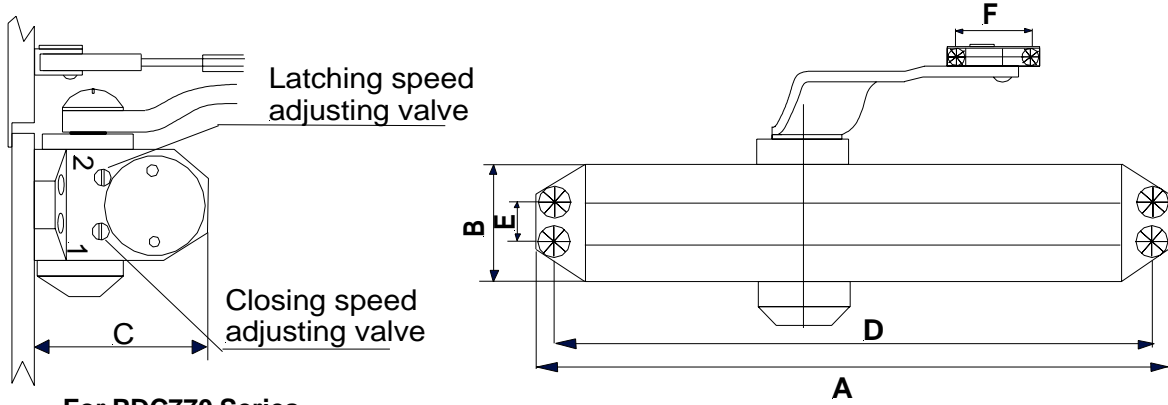

For PDC770 Series

	A	B	C	D	E	F
PDC771/1/2/3	180	44	65	165	19	45

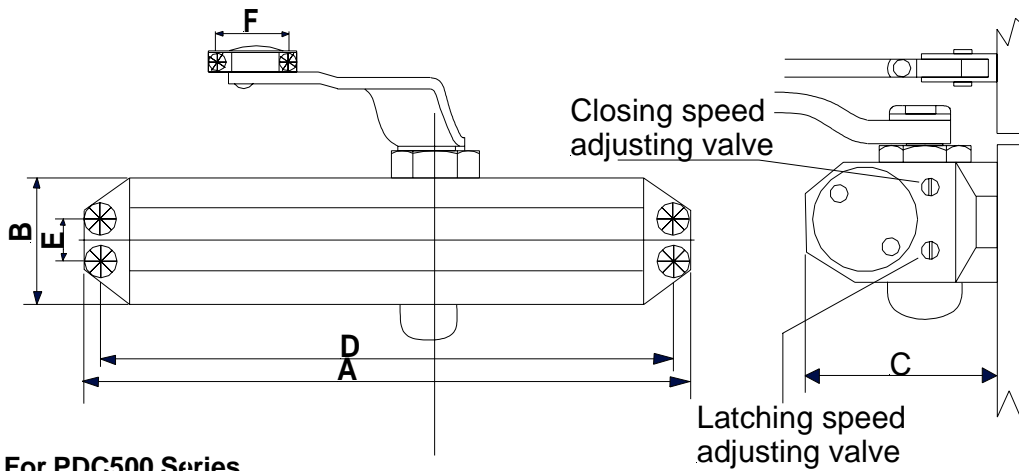

For PDC500 Series

	A	B	C	D	E	F
PDC505	245	45	72	230	19	45

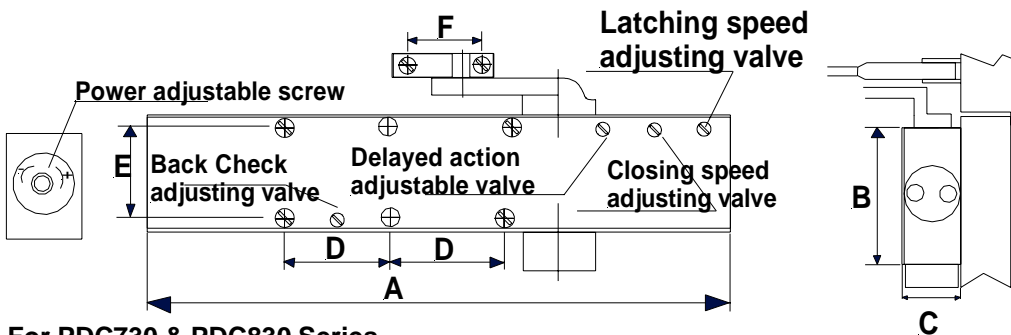

For PDC730 & PDC830 Series

	A	B	C	D	E	F
PDC732	207	60	38.5	50	43	45
PDC733	207	60	38.5	50	43	45
PDC734	207	60	38.5	50	43	45
PDC735	246	62	45	50	43	45
PDC835	236	60	38.5	50	43	45
PDC836	275	62	45	50	43	45

Dimensions & Technical Details PFS 840 Series

H a r d w a r e A c c e s s o r i e s

Standard arm set

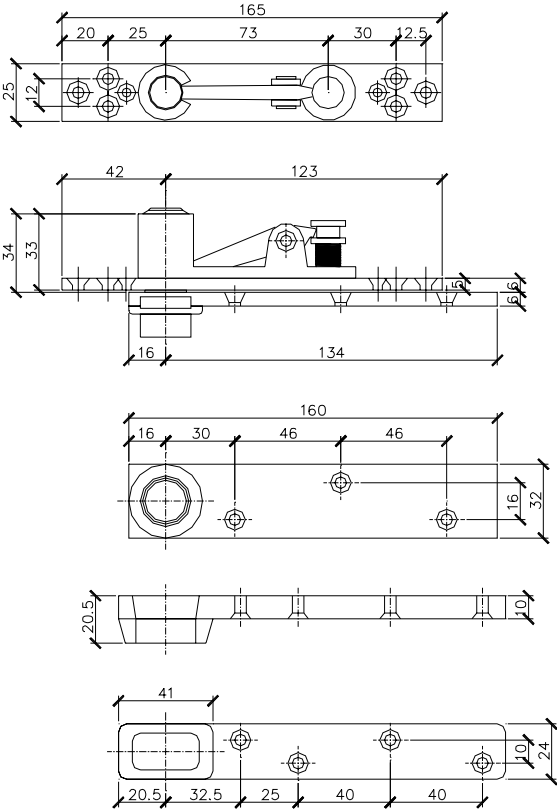

Accessories for single action timber door

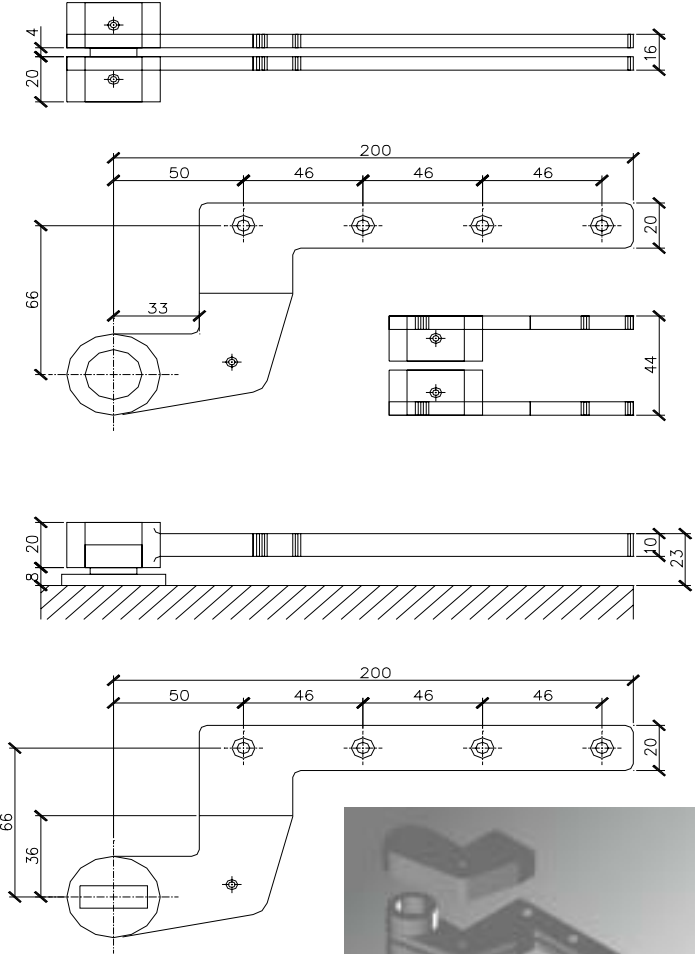

- 1 Top centre
- 2 Bottom arm
- 3 Cover caps for Top centre
- 4 Cover caps for bottom arm

Dimensions & Technical Details

H a r d w a r e A c c e s s o r i e s

Special accessories for transom closer

Forged steel arm with channel.

End load bottom pivot.

